

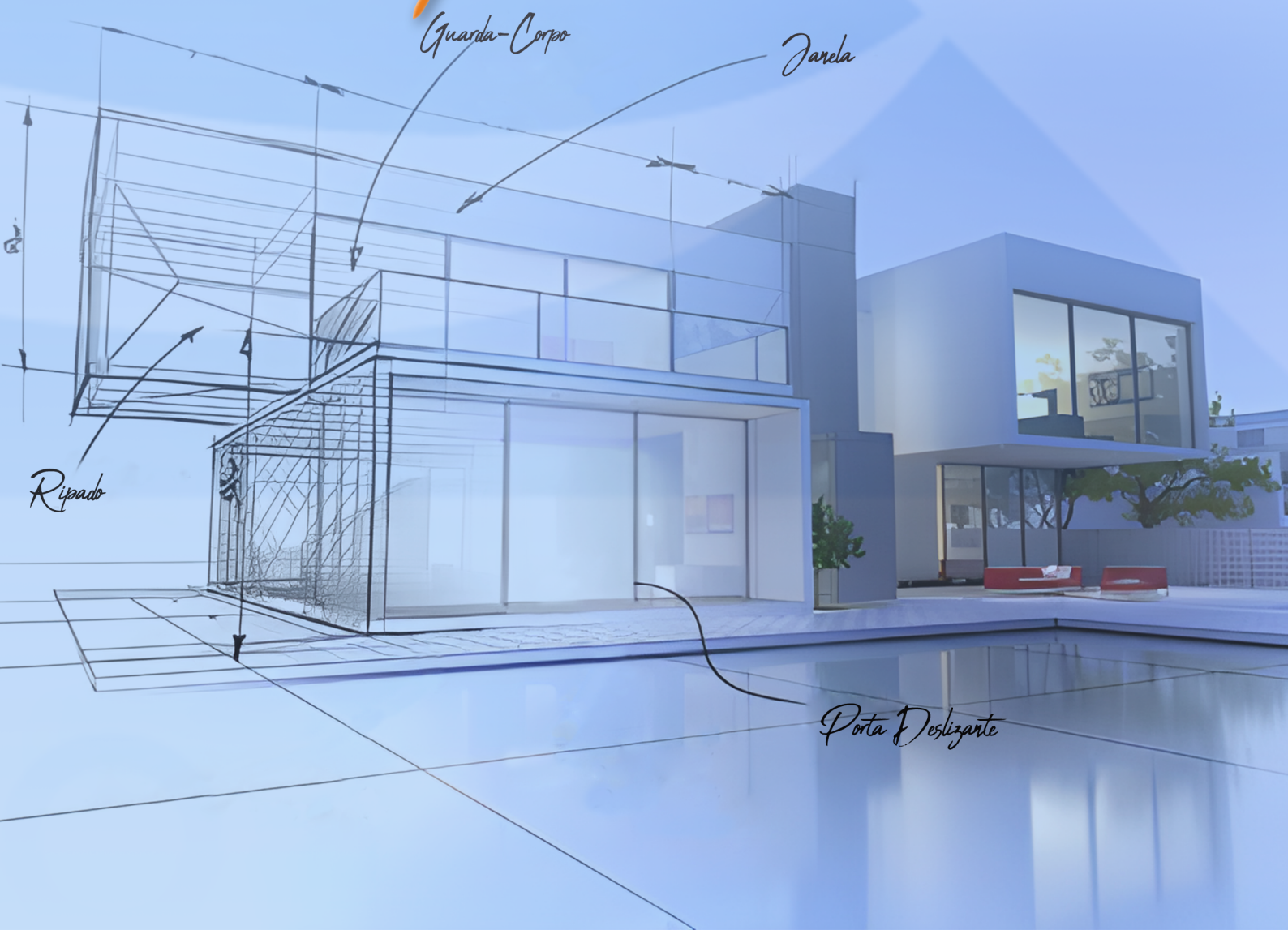

GRUPO
ALUCENTRO
Desde 1982

LINHA

Atlanta



Guarda-Corpo

Janela

Ripado

Porta Deslizante

Código	Página
FA-204	02
FA-205	02
FA-400	02
FA-200	02
FA-390	02
FA-211	02
FA-294	03
FA-516	03
FA-260	03
FA-347	03
FA-235	03
FA-515	03
FA-333	04
FA-228	04
FA-232	04
FA-245	04
FA-230	04
FA-255	04
FA-256	05

FA-204
1,010 KG/M

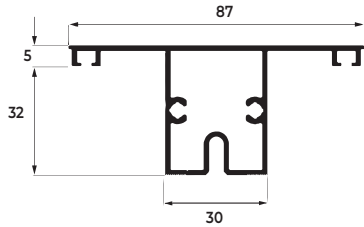

TRAVESSA INTERMEDIÁRIA

FA-205
0,920 KG/M

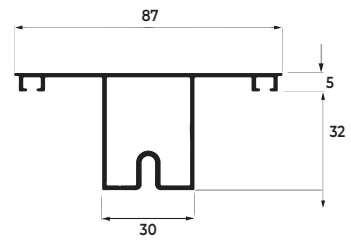

TRAVESSA INTERMEDIÁRIA

FA-400
1,488 KG/M

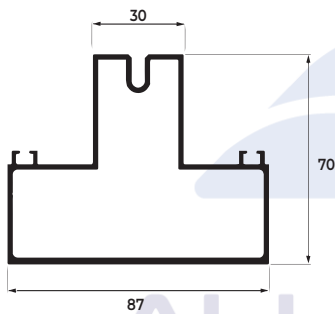

COLUNA CENTRAL

FA-200
1,952 KG/M

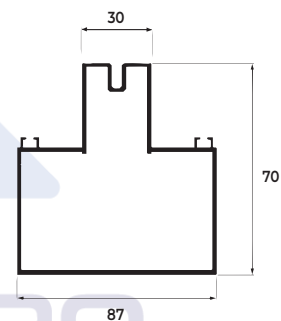

COLUNA CENTRAL

FA-390
3,360 KG/M

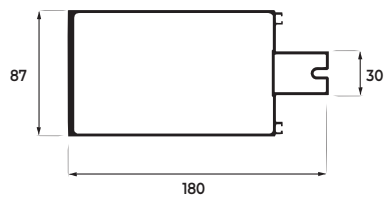

COLUNA CENTRAL

FA-211
0,993 KG/M

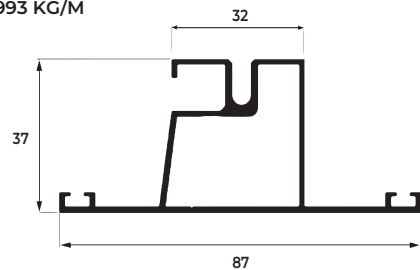

TRAVESSA INTERMEDIÁRIA

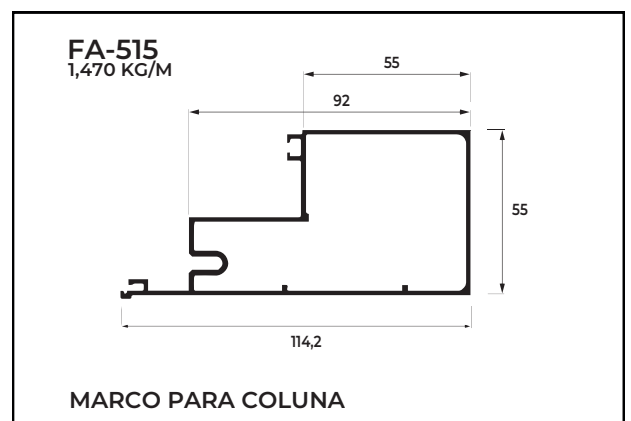
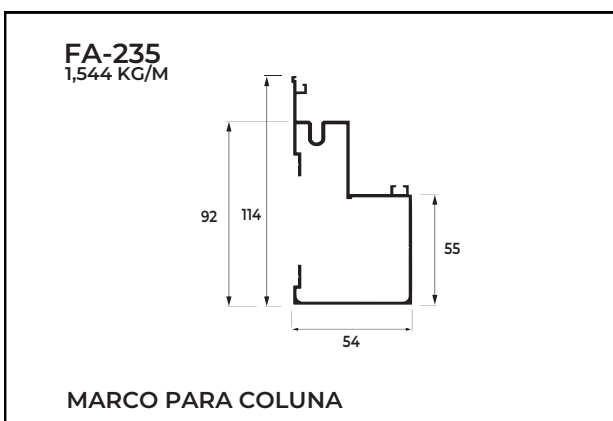
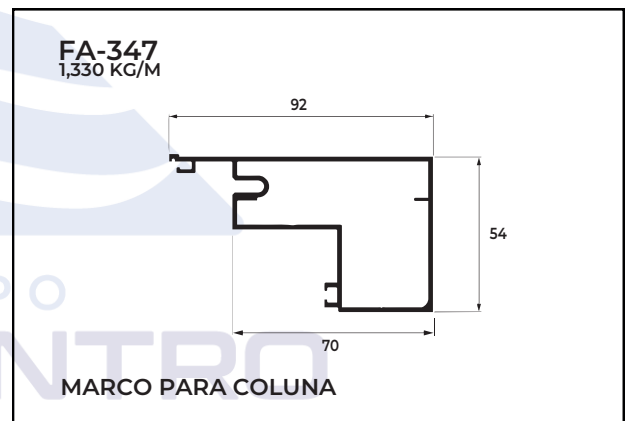
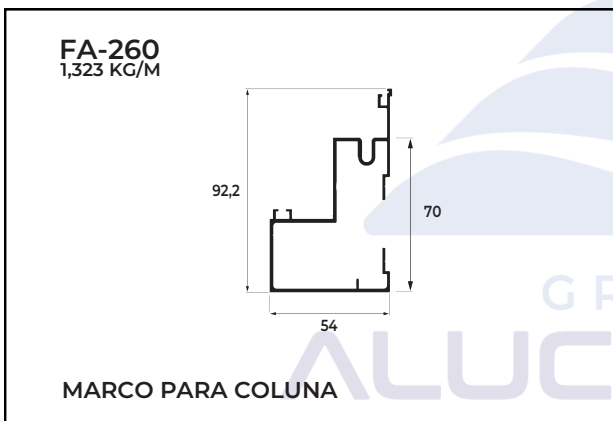
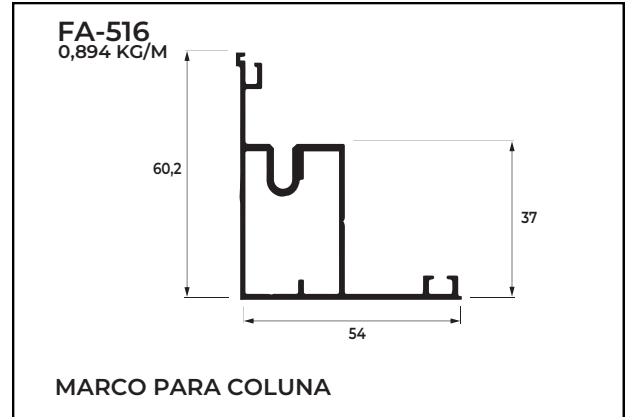
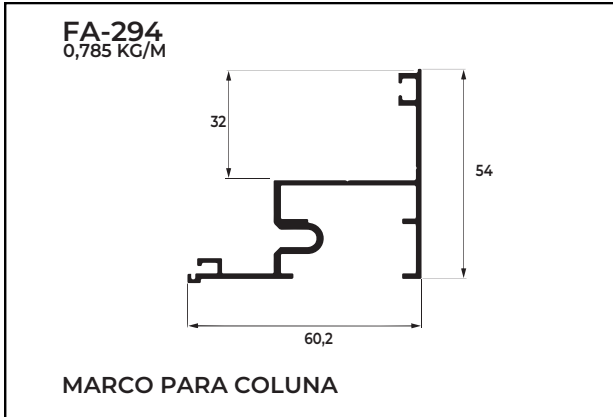

FA-333
2,106 KG/M

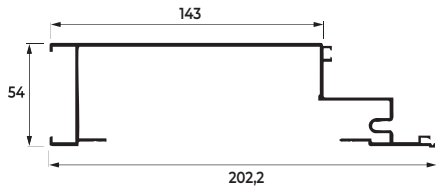

MARCO PARA COLUNA

FA-228
0,568 KG/M

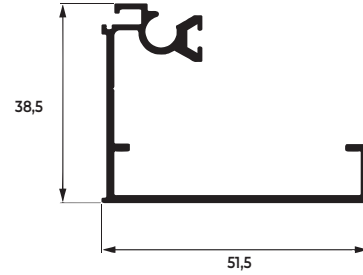

MONTANTE DO QUADRO FIXO

FA-232
0,603 KG/M

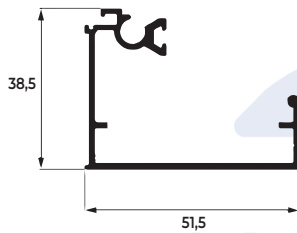

TRAVESSA SUPERIOR E INFERIOR DO QUADRO FIXO

FA-245
0,745 KG/M

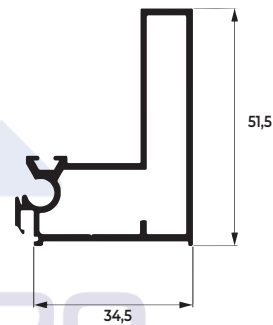

MONTANTE PARA FOLHA MÓVEL

FA-230
0,777 KG/M

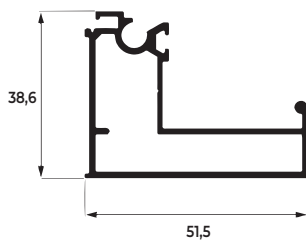

TRAVESSA SUPERIOR DA FOLHA MÓVEL

FA-255
0,765 KG/M

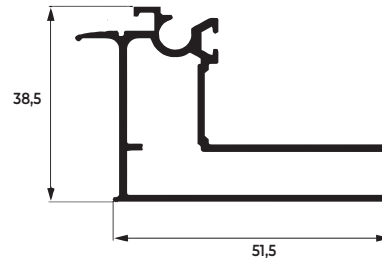

MONTANTE DA FOLHA MÓVEL

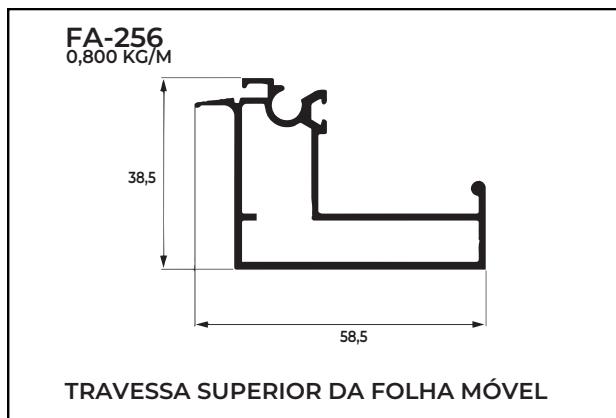

GRUPO
ALUCENTRO
Desde 1982